

Cam Followers

CF-SB SERIES

Sealed, Hex Holes. Measurements In Inches.

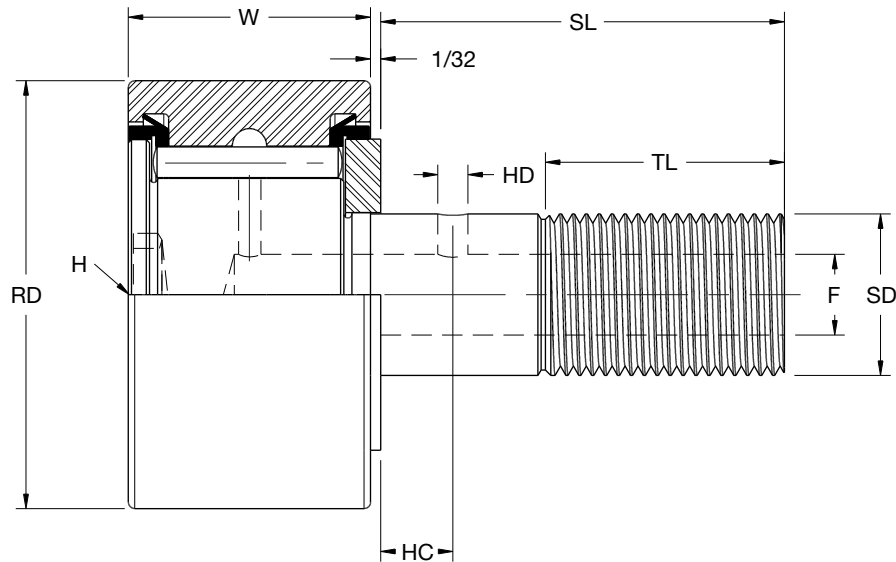

Axis Part Number	Roller Dia +0.000/-0.001	Roller Width +0.000/-0.005	Stud Dia	Stud Length	Min. Thread Length	Fine Threads	Oil Hole Center	Oil Hole Dia.	Lube Fitting Size	Min Boss Dia.	Housing Bore Dia +0.0002/-0.0003	Recom. Clamping Torque ¹	Max Static Capacity	Basic Dyn Capacity	Limiting Speed	Hex Wrench Size
	RD	OW	SD	SL	TL		HC	HD	F			Lbs-In	Lbs	Lbs	RPM	H
CF 1/2 N SB	0.5000	0.3440	0.1900	1/2	1/4	10-32				19/64	0.1903	15	720	620	5100	1/8
CF 1/2 SB	0.5000	0.3750	0.1900	5/8	1/4	10-32				19/64	0.1903	15	790	680	5100	1/8
CF 9/16 SB	0.5625	0.3750	0.1900	5/8	1/4	10-32				19/64	0.1903	15	790	680	5100	1/8
CF 5/8 N SB	0.6250	0.4060	0.2500	5/8	5/16	1/4-28				23/64	0.2503	35	1085	930	4300	1/8
CF 5/8 SB	0.6250	0.4375	0.2500	3/4	5/16	1/4-28				23/64	0.2503	35	1215	955	4300	1/8
CF 11/16 SB	0.6875	0.4375	0.2500	3/4	5/16	1/4-28				23/64	0.2503	35	1215	955	4300	1/8
CF 3/4 SB	0.7500	0.5000	0.3750	7/8	3/8	3/8-24	1/4	3/32	3/16	1/2	0.3753	95	2065	1660	3400	3/16
CF 7/8 SB	0.8750	0.5000	0.3750	7/8	3/8	3/8-24	1/4	3/32	3/16	1/2	0.3753	95	2065	1660	3400	3/16
CF 1 SB	1.0000	0.6250	0.4375	1	1/2	7/16-20	1/4	3/32	3/16	41/64	0.4378	250	3060	2225	2900	1/4
CF 1 1/8 SB	1.1250	0.6250	0.4375	1	1/2	7/16-20	1/4	3/32	3/16	41/64	0.4378	250	3060	2225	2900	1/4
CF 1 1/4 SB	1.2500	0.7500	0.5000	1 1/4	5/8	1/2-20	5/16	3/32	3/16	49/64	0.5003	350	4250	3930	2400	1/4
CF 1 3/8 SB	1.3750	0.7500	0.5000	1 1/4	5/8	1/2-20	5/16	3/32	3/16	49/64	0.5003	350	4250	3930	2400	1/4
CF 1 1/2 SB	1.5000	0.8750	0.6250	1 1/2	3/4	5/8-18	3/8	3/32	3/16	57/64	0.6253	650	5640	4840	2000	5/16
CF 1 5/8 SB	1.6250	0.8750	0.6250	1 1/2	3/4	5/8-18	3/8	3/32	3/16	57/64	0.6253	650	5640	4840	2000	5/16
CF 1 3/4 SB	1.7500	1.0000	0.7500	1 3/4	7/8	3/4-16	7/16	3/32	3/16	1 3/64	0.7503	1250	7920	6385	1700	5/16
CF 1 7/8 SB	1.8750	1.0000	0.7500	1 3/4	7/8	3/4-16	7/16	3/32	3/16	1 3/64	0.7503	1250	7920	6385	1700	5/16
CF 2 SB	2.0000	1.2500	0.8750	2	1	7/8-14	1/2	1/8	3/16	1 13/64	0.8753	1500	10570	8090	1500	7/16
CF 2 1/4 SB	2.2500	1.2500	0.8750	2	1	7/8-14	1/2	1/8	3/16	1 13/64	0.8753	1500	10570	8090	1500	7/16
CF 2 1/2 SB	2.5000	1.5000	1.0000	2 1/4	1 1/8	1-14	9/16	1/8	3/16	1 5/16	1.0003	2250	16450	11720	1100	1/2
CF 2 3/4 SB	2.7500	1.5000	1.0000	2 1/4	1 1/8	1-14	9/16	1/8	3/16	1 5/16	1.0003	2250	16450	11720	1100	1/2
CF 3 SB	3.0000	1.7500	1.2500	2 1/2	1 1/4	1 1/4-12	5/8	1/8	1/4 ²	1 3/4	1.2503	3450	24910	15720	850	3/4
CF 3 1/4 SB	3.2500	1.7500	1.2500	2 1/2	1 1/4	1 1/4-12	5/8	1/8	1/4 ²	1 3/4	1.2503	3450	24910	15720	850	3/4
CF 3 1/2 SB	3.5000	2.0000	1.3750	2 3/4	1 3/8	1 3/8-12	11/16	1/8	1/4 ²	1 59/64	1.3753	4200	31625	22800	800	3/4
CF 4 SB	4.0000	2.2500	1.5000	3 1/2	1 1/2	1 1/2-12	3/4	1/8	1/4 ²	2 9/32	1.5003	5000	44770	29985	700	3/4

¹ Based on dry threads. If lubricated, use half of values shown.

² Lubrication hole (F) is located at bottom of hex hole. 1/4 inch straight drive fitting with ball check supplied, but not installed.